

MJP 500 / 550 Series - Shaft Seal Mk1

Assembly

Pos	Qty	Part No	Description
1	1		Shaft seal
		34025	(complete seal assy w/o wear sleeve - to shaft diameter 90 mm)
		34029	(complete seal assy- to shaft diameter 90 mm)
		34027	(complete seal assy- to shaft diameter 100 mm)
2*			Radial Seal
	3	34034	(to wear sleeve WS-90 and shaft seals 34027, 34029)
	3	34024	(to shafts w/o wear sleeve)
3	1		Wear sleeve
		WS-90	(to 90 mm shaft)
		WS-100	(to 100 mm shaft)
4	2		O-ring
		32050	(to 90 mm shaft)
		32033	(to 100 mm shaft)
5	1	50311	Shaft seal hose
6	4	HC - 168	Hose Clamp (to Shaft Seal Hose 50311)
7	1	34053	Shaft Seal Housing (incl. bearing and lock ring)
8	6	22000	Lockwasher (set)
9	6	21003	Socket head screw
10	1	23105	Thordon Bearing

MJP 550 Series - Shaft Seal Mk4

Assembly

Pos	Qty	Part No	Description
1	1	34026	Shaft seal
			(complete seal assy- to shaft diameter 105 mm)
2*	3	34034	Radial Seal
3	1	WS-105	Wear sleeve
			(to 105 mm shaft)
4	2	32035	O-ring
5	1	50311	Shaft seal hose
6	4	HC - 168	Hose Clamp (to Shaft Seal Hose 50311)
7	1	34053	Shaft Seal Housing (incl. bearing and lock ring)
8	6	22000	Lockwasher (set)
9	6	21016	Socket head screw
10	1	23105	Thordon Bearing

MJP 500/550 Series - Pump Unit Mk1

Assembly

Pos	Qty	Part No	Description
2*	1	80251	Impeller
3	2	32051	O-ring
4	6	21043	Socket head screw
5	6	22000	Lock washer
6	1	24104	Lock ring - coupling
7	1	32052	O-ring
8	1	32047	O-ring
9a	12	21033 A	Socket head screw
9b	16	21074	Socket head screw (Catalina Jet -USA only)
10	12/16	22001	Lock washer
11	2	51009	Lub oil pipe
13	6	32059	O-ring (3pcs/pipe)
16*	1	32515	Diffuser
17	18	21015	Hex head screw
18	18	22002	Lock washer
19	1	32075	O-ring
20	1	32048	O-ring
21	11	21022	Socket head screw
22	11	22001	Lock washer
23	12	21038	Hex head screw
24	12	22001	Lock washer

60002 **Assembly Kit 550 Mk1 - Seal exchange**
(Needed bolts, washers and o-rings for reassembly after seal change)

MJP 550 Series - Pump Unit Mk2

Assembly

Pos	Qty	Part No	Description
2*	1	80251	Impeller
3	2	32051	O-ring
4	8	21007	Socket head screw
5	8	22004	Lock washer
6	1	24122	Lock ring - coupling
7	1	32035	O-ring
8	1	32047	O-ring
9	30	21074	Socket head screw
10	30	22001	Lock washer
11	1	51015 S	Lub oil pipe, short
11 b	1	51015 L	Lub oil pipe, long
12	2	32101	O-ring
13	6	32059	O-ring (3pcs/pipe)
14	2	21042	Hex head screw
15	2	22000	Lock washer
16*	1	32535	Diffuser
17	18	21015	Hex head screw
18	18	22002	Lock washer
19	1	32068	O-ring
20	1	32036	O-ring
21	11	21067	Socket head screw
22	11	22010	Lock washer
23	24	21073	Socket head screw
24	24	22001	Lock washer
25	1	32082	O-ring

60003 **Assembly Kit 550 Mk2 - Seal exchange**
(Needed bolts, washers and o-rings for reassembly after seal change)

MJP 550 Series - Hub Unit Mk1

Assembly

Pos	Qty	Part No	Description
1	1	44160	Coupling Fits early model Disc Pack part no 42030:
2b	1	21071	Coupling Bolt Set (set of 8 Bolts and nuts - only to Catalina Jet, USA) Fits new model Disc Pack part no 42026:
2c	1	21076	Coupling Bolts (set of 8 pcs)
2c	1	21083	Coupling Nuts (set of 4 pcs)
4	1	42026	Disc pack (incl. bolts, nuts and washers) new model

Part nos: 21035 Short, 21035 Long and 23049 are no longer available

26	1	43161	Exchange Bearing Unit - tuned and ready for quick exchange - containing all parts from pos 6 to 21
6	1	44201	Flange Special -only for Catalina Jet, USA
6	1	44202	Flange
7	8	21019	Socket head screw
8	8	22001	Lock washer
9	1		Mechanical Seal
		34001	New
		34001 R	Refurbished (customer must return old seal)
10	1	44131	Lid
11	8	21016	Socket head screw
12	8	22000	Lock washer
13	1	32049	O-ring
14	1	32086	O-ring
15	1	44211	Stub Shaft
16	1	43101	Conical Roller Bearing
17	1	44171	Bearing Housing
18	2	33011	Plug for disassemble
19	1	43102	Spherical Roller Bearing
20	1	43171	Support Washer
21	1	23030	Nut

22	1	44101	Cap
23	8	21016	Socket head screw
24	8	22000	Lock washer
25	2	32049	O-ring

MJP 500/550 Series - Hub Units

Model	Manufactured
500/550 Mk1	1987 - 2000
550 Mk2	From 2000

MJP 550 Series - Hub Unit Mk2

Coupling

dwg 553-11090

Pos	Qty	Part No	Description
1	1	42035	Disc pack (incl. bolts, nuts and washers)
2	1	44161	Coupling
3	1	44150	Flanged shaft
4	8	22008	Washer
5	1	23049 B	Coupling Nuts (set of 8 pcs)
6	1	21075 B	Coupling Bolts (set of 8 pcs)
7	1	24122	Lock Ring
8	1	32035	O-ring
9	8	21007	Screw
10	8	22004	Lock Washer
11	1	43172	Support Washer
12	1	23025	Nut KMT

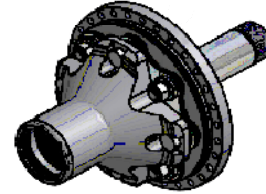

Hub

dwg 553-1005E

Pos	Qty	Part No	Description
1	12	22000	Lock washer
2	1	44172	Bearing Housing
3	1	43101	Conical Roller Bearing
4	1	43103	Spherical Roller Bearing
5	1	43104	OK Coupling
6	1	44132	Lid
7	12	21043	Socket Head Screw
8	1	-	Sealing Strip
9	1	-	Seat
10	1	33997	Mechanical Seal Housing
11	1		Mechanical Seal
		34008	New
		34008 R	Refurbished (customer must return old seal)
12	4	21000	Socket head screw
13	1	43181	Support Washer
14	1	23025	Nut KMT
15	1	32038	O-ring
16	1	43188	Spacer Ring
17	1	32100	O-ring
18	2	33011	Plug for disassemble
19	1	43172	Support Washer
20	1	23026	Nut KMT



43162 **Exchange Bearing Unit - tuned and ready for quick exchange**
containing all parts from pos 1 to 18

MJP 500 Series - Steering Unit Mk1

Assembly

Pos	Qty	Part No	Description	
1	1	32514	Nozzle	
2	1	32522	Steering nozzle	
3	1	32510	Visor	
4	1	32513	Bucket	
5	2	32521	Link arm	(sold in pairs)
6	2	24111	Pin shaft	(link arm/visor)
6	2	24111	Pin shaft	(link arm/bucket)
7	2	24110	Pin shaft	(bucket)
8	2	24108	Pin shaft	(visor)
9	2	24112	Pin shaft	(steering nozzle)
11a	4	24109	Pin shaft	(steering cyl.)
11a	4	24109	Pin shaft	(reversing cyl.)
11b	2	24260	Washer	(reversing cyl.)
12	2	35052	Bushing	(bucket)
13	2	24240	Securing plate SS	(to be welded)
14	2	35050	Bushing	(steering nozzle)
15	2	24241	Securing plate	(to be welded)
16	4	35053	Bushing	(link arm)
17	4	24243	Securing plate SS	(to be welded)
18	2	35051	Bushing	(visor)
19	2	24240	Securing plate SS	(to be welded)
20	2	23080	Cotter pin	(steering cyl.)
20	4	23080	Cotter pin	(reversing cyl.)
		32302	Pin Shaft Set - 500 Mk1	
		32202	Bushing set - 500 Mk1	

MJP 500 Series - Steering Unit

Model	Manufactured	Description
Mk 1	1994 -	

MJP 550 Series - Steering Unit Mk2

Assembly

Pos	Qty	Part No	Description	
1	1	32534	Nozzle	
2	1	32532	Steering nozzle	
3	1	32530	Visor	
4	1	32533	Bucket	
5	2	32531	Link arm	(sold in pairs)
6	2	24033	Pin Shaft	(link arm/visor)
6	2	24034	Pin Shaft	(link arm/bucket)
7	2	24032	Pin Shaft	(bucket)
8	2	24031	Pin Shaft	(visor)
9	2	24030	Pin Shaft	(steering nozzle)
11a	4	24069	Pin Shaft	(steering cyl.)
11b	4	24035	Pin Shaft	(reversing cyl.)
11c		24260	Washer	(reversing cyl.)
12	2	35047	Bushing	(bucket)
13	2	24240	Securing plate SS	(to be welded)
14	2	35046	Bushing	(steering nozzle)
15	2	24241	Securing plate	(to be welded)
16	4	35049	Bushing	(link arm)
17	4	24243	Securing plate SS	(to be welded)
18	2	35047	Bushing	(visor)
19	2	24240	Securing plate SS	(to be welded)
20	2	23080	Cotter pin	(steering cyl.)
20	4	23080	Cotter pin	(reversing cyl.)
		32306	Pin Shaft Set -550 Mk2	
		32206	Bushing Set - 550 Mk2	

MJP 550 Series - Steering Unit

Model	Manufactured	Description
Mk 1	1988 - 1998	
Mk 2	1998 -	
-		Prices to 550 Mk1 on request
-		Old models can be upgraded with newer steering parts. Contact MJP for information.

Hydraulic Hose Arrangement

MJP 500 Series - From 1987

Pos	Qty	Part No	Description		
1	2	51359-A	Hydraulic Hose (Reversing Cyl.)	90° - 90°	L=430
2	2	51359-A	Hydraulic Hose (Reversing Cyl.)	90° - 90°	L=450
3	2	51360-C	Hydraulic Hose (Steering Cyl.)	0° - 90°	L=1130
4	2	51360-A	Hydraulic Hose (Steering Cyl.)	0° - 90°	L=500
5	2	51354-A	Protection Hose (Reversing Cyl.)	open - 0°	L=960
6	2	51354-A	Protection Hose (Steering Cyl.)	open - 0°	L=290
7	18	40604	Connector (male/male)	3/8" - 3/8"	
8	18	51205	Bonded Seal	3/8"	

All 450 / 500 Series hoses are 3/8" unless specified

Hydraulic Hose Arrangement

MJP 550 Series - 1987 - 2000

Pos	Qty	Part No	Description		
1	2	51359-A	Hydraulic Hose (Reversing Cyl.)	90° - 90°	L=430
2	2	51360-B	Hydraulic Hose (Reversing Cyl.)	0° - 90°	L=780
3	2	51360-A	Hydraulic Hose (Steering Cyl.)	0° - 90°	L=280
4	2	51360-A	Hydraulic Hose (Steering Cyl.)	0° - 90°	L=400
5	2	51354-B	Protection Hose 3/8" (Reversing Cyl.)	open - 0°	L=1300
6	2	51354-A	Protection Hose 3/8" (Steering Cyl.)	open - 0°	L=800
7	16	40604	Connector (male/male)	3/8" - 3/8"	
8	16	51205	Bonded Seal	3/8"	
9	4	40603	Connector (male/male)	1/2" - 3/8"	
10	4	51203	Bonded Seal	1/2"	
11	1	51302	Clamp	2 x 3/8"	

NOTE

Above is standard.
Different lengths may exist - always measure length to avoid faulty purchase orders
See reference page.

Hydraulic Hose Arrangement

MJP 550 Series - From 2000

Pos	Qty	Part No	Description		
1	2	51351-A	Hydraulic Hose (Reversing Cyl.)	90° - 90°	L=400
2	2	51352-A	Hydraulic Hose (Reversing Cyl.)	0° - 90°	L=1000
3	2	51352-A	Hydraulic Hose (Steering Cyl.)	0° - 90°	L=620
4	2	51352-A	Hydraulic Hose (Steering Cyl.)	0° - 90°	L=500
5	1	51353-A	Protection Hose 3/8" (Reversing Cyl.)	open -90*	L=1500
6	1	51353-A	Protection Hose 3/8" (Steering Cyl.)	open -90*	L=1040
7	16	40602	Connector (male/male)	1/2"	
8	16	51203	Bonded Seal	1/2"	
9	4	40604	Connector (male/male)	3/8" - 3/8"	
10	4	51205	Bonded Seal	3/8"	
11	1	51421L	Hydraulic connection block 1/2" (PORT side seen from aft)		
12	1	51353-A	Protection Hose 3/8" (Steering Cyl.)	0° - 90°	L=830
13	1	51353-A	Protection Hose 3/8" (Reversing Cyl.)	0° - 90°	L=1470
14	2	51353-A	Protection Hose 3/8" (Trim Tab cylinder)	0° - 90°	L=400
15	1	51421R	Hydraulic connection block 1/2" (STBD side seen from aft)		

NOTE

Above is standard.

Different lengths may exist - always measure length to avoid faulty purchase orders

See reference page.